

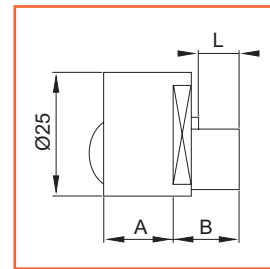



Cilindro tondo per centrale PREFER

. Cilindro tondo in ottone con 2 chiavi.
 . Per art. 0711 - 6211 - 6212 - 6411 - 6412 - 6511.



6810

Codice SPS	Articolo	L mm.	A mm.	B mm.	Perni	Imb.	UM	EAN
SPR6810.000	6810.0000	5,2	11	12,5	3	25	PZ	8 032541 126767
SPR6810.008	6810.0008	2,5	31,5	10	4	15	PZ	8 032541 127047
SPR6810.010	6810.000A	3,3	39,5	11	4	10	PZ	8 032541 127054
SPR6810.000.K.A	6810.000.K.A	5,2	11	12,5	3	25	PZ	8 032541 126804

Cilindro tondo per basculante PREFER

. Cilindro tondo in ottone con 2 chiavi.
 . Per art. 6551.

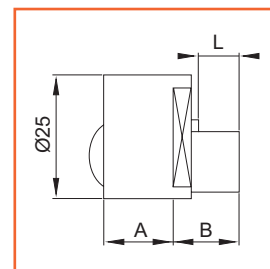

6811

Codice SPS	Articolo	L mm.	A mm.	B mm.	Perni	Imb.	UM	EAN
SPR6811.000	6811.0000	7,9	11	12,5	3	25	PZ	8 032541 127511
SPR6811.002	6811.0002	7,9	14	13	4	25	PZ	8 032541 127559
SPR6811.004	6811.0004	3,9	18	9	4	25	PZ	8 032541 127634
SPR6811.000.K.A	6811.0000 K.A.	7,9	11	12,5	3	25	PZ	8 032541 127542

Cilindro tondo per verticale PREFER

. Cilindro tondo in ottone con 2 chiavi.
 . Per art. 6311 - 6312 - 6313 - 6315 - 6316.

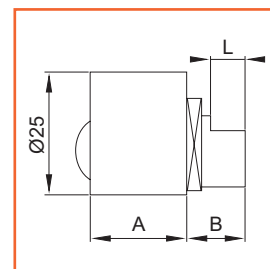
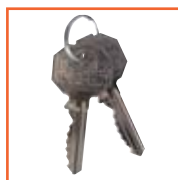

6813

Codice SPS	Articolo	L mm.	A mm.	B mm.	Perni	Imb.	UM	EAN
SPR6813.002	6813.0002	5,2	14	13	3	25	PZ	8 032541 127948



Cilindro PREFER per cancelletti estensibili

. Cilindro in ottone con 2 chiavi.
 . Per art. 6610.

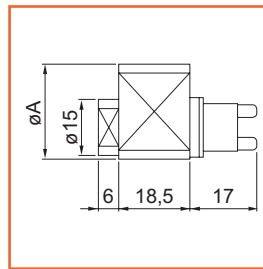
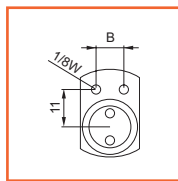
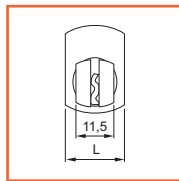

Codice SPS	Articolo	L mm.	A mm.	B mm.	Perni	Imb.	UM	EAN
SPR6818.000	6818.0000	15,8	25	8,5	4	25	PZ	



6818

Cilindro PREFER per serrande scorrevoli

. Cilindro in ottone con 2 chiavi.
 . Per art. 6317 - 6318.

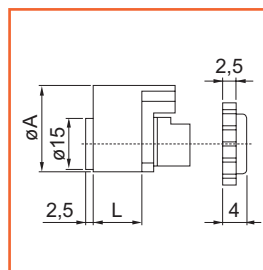
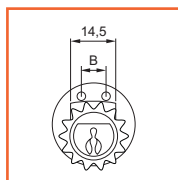

Codice SPS	Articolo	L mm.	A mm.	B mm.	Perni	Imb.	UM	EAN
SPR6819.000	6819.0000	14,5	25	8,5	4	25	PZ	



6819

Cilindro sagomato PREFER

. Cilindro sagomato da infilare in ottone con 2 chiavi.
 . Camma DIN sporgente.

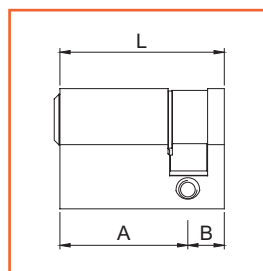
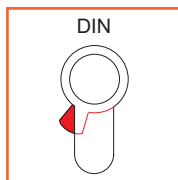

Codice SPS	Articolo	L mm.	A mm.	B mm.	Perni	Imb.	UM	EAN
SPR6861.000	6861.0000	33	22,5	10,5	4	10	PZ	
SPR6861.002	6861.0002	40,5	30	10,5	4	10	PZ	
SPR6861.004	6861.0004	50,5	40	10,5	4	10	PZ	
SPR6861.006	6861.0006	65,5	55	10,5	4	10	PZ	
SPR6861.008	6861.0008	85,5	75	10,5	4	10	PZ	
SPR6861.000 KA	6861.0000 K.A.	33	22,5	10,5	4	10	PZ	



6861