

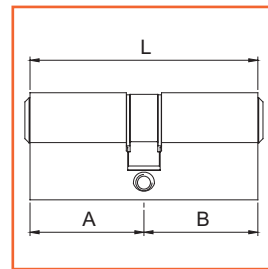

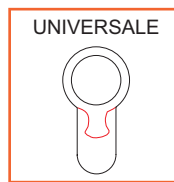

Doppio cilindro WELKA serie 600

- . Cilindro in ottone, leva centrale.
- . Tre chiavi in dotazione.

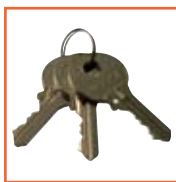

600

Codice SPS	Articolo	L mm.	A mm.	B mm.	Perni	Imb.	UM	EAN
SWE600.22.220	600.22.22.0	54	27	27	4	1	PZ	8 021012 027467
SWE600.22.280	600.22.28.0	60	27	33	4	1	PZ	8 021012 027474
SWE600.22.340	600.22.34.0	66	27	39	4	1	PZ	8 021012 027481
SWE600.22.380	600.22.38.0	70	27	43	4	1	PZ	8 021012 027498

Doppio cilindro WELKA serie 700

- . Cilindro in ottone, leva DIN sporgente 30°.
- . Tre chiavi in dotazione.

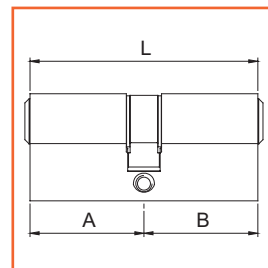
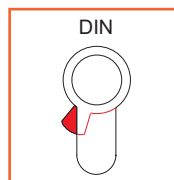
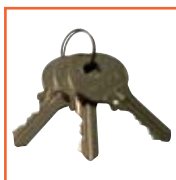

700

Codice SPS	Articolo	L mm.	A mm.	B mm.	Perni	Imb.	UM	EAN
SWE700.22.220	700.22.22.0	54	27	27	4	1	PZ	8 021012 028402
SWE700.22.280	700.22.28.0	60	27	33	4	1	PZ	8 021012 028419
SWE700.26.260	700.26.26.0	62	31	31	5	1	PZ	8 021012 028464
SWE700.22.340	700.22.34.0	66	27	39	4	1	PZ	8 021012 028426
SWE700.22.380	700.22.38.0	70	27	43	4	1	PZ	8 021012 028433
SWE700.30.300	700.30.30.0	70	35	35	5	1	PZ	8 021012 028525
SWE700.22.420	700.22.42.0	74	27	47	4	1	PZ	8 021012 028440
SWE700.34.340	700.34.34.0	78	39	39	5	1	PZ	8 021012 028532
SWE700.22.480	700.22.48.0	80	27	53	4	1	PZ	8 021012 028457

Doppio cilindro WELKA ovale

- . Cilindro ovale in ottone mm. 13x28, leva centrale.
- . Tre chiavi in dotazione.

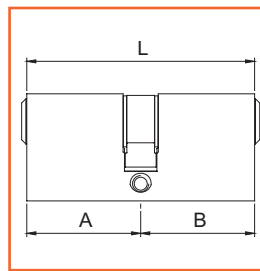
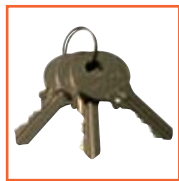

Codice SPS	Articolo	L mm.	A mm.	B mm.	Perni	Imb.	UM	EAN
SWE702.22.220	702.22.22.0	54	27	27	4	1	PZ	8 021012 030191
SWE702.22.280	702.22.28.0	60	27	33	4	1	PZ	8 021012 030207
SWE702.25.250	702.25.25.0	60	30	30	4	1	PZ	8 021012 030252
SWE702.22.380	702.22.38.0	70	27	43	4	1	PZ	8 021012 030221



702

Cilindro fisso WELKA

- . Cilindro fisso in ottone per ferroglietti.
- . Art. 603.00 per ferroglietti serie 010 e 011.
- . Art. 603.02 per ferroglietti serie 012 (nuovi).
- . Tre chiavi in dotazione.

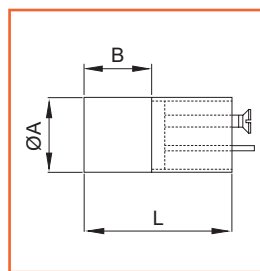
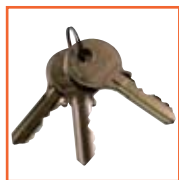

Codice SPS	Articolo	L mm.	A mm.	B mm.	Perni	Imb.	UM	EAN
SWE603.00.000	603.00.00.0	50	25	26	5	10	PZ	8 021012 027719
SWE603.02.000	603.02.00.0	50	25	23,5	5	10	PZ	8 021012 000545



603

Cilindro staccato WELKA

- . Cilindro staccato ottonato.
- . Tre chiavi in dotazione.

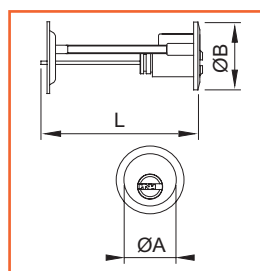
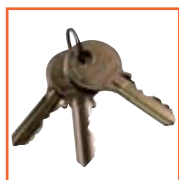

Codice SPS	Articolo	L mm.	A mm.	B mm.	Perni	Imb.	UM	EAN
SWE604.00.000	604.00.00.0	90	25	40	5	10	PZ	8 021012 027740

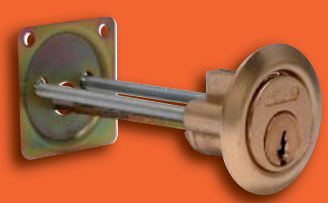

604



Coppia cilindri WELKA

- . Coppia cilindri ottonati.
- . Tre chiavi in dotazione.

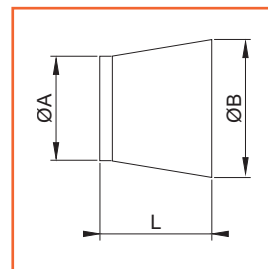

Codice SPS

Articolo

L mm.

A mm.

B mm.

Perni

Imb.

UM

EAN

SWE605.00.000

605.00.00.0

20

25

31

4

10

PZ



605

Cilindro tondo WELKA mm. 22

- . Cilindro tondo in ottone diametro mm. 22, leva centrale.
- . Tre chiavi in dotazione.

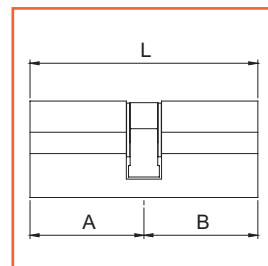
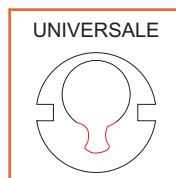
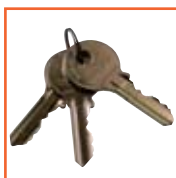

Codice SPS

Articolo

L mm.

A mm.

B mm.

Perni

Imb.

UM

EAN

SWE607.22.220

607.22.22.0

54

27

27

4

1

PZ



SWE607.22.280

607.22.28.0

60

27

33

4

1

PZ



SWE607.22.380

607.22.38.0

70

27

43

4

1

PZ



SWE607.22.480

607.22.48.0

80

27

53

4

1

PZ



SWE607.22.220.KA

607.22.22.0KA

54

27

27

4

1

PZ



607

Cilindro tondo WELKA mm. 25

- . Doppio cilindro in ottone massiccio trafilato e decapato con 3 chiavi in ottone nichelato e vite di fissaggio
- . Pistoncini e contropistoncini in ottone, molle in bronzo fosforoso
- . Camma DIN sporgente antistrappo.

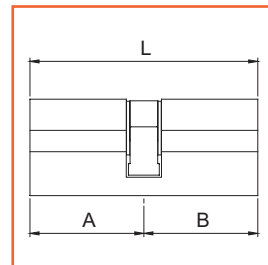
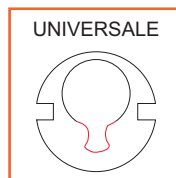
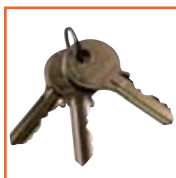

Codice SPS

Articolo

L mm.

A mm.

B mm.

Perni

Imb.

UM

EAN

SWE608.22.220

608.22.22.0

54

27

27

4

1

PZ



SWE608.22.280

608.22.28.0

60

27

33

4

1

PZ



SWE608.22.380

608.22.38.0

70

27

43

4

1

PZ



SWE608.22.480

608.22.48.0

80

27

53

4

1

PZ



SWE608.22.220.KA

608.22.22.0KA

54

27

27

4

1

PZ



180



608

Borchia WELKA per cilindri tondi

. Borchia in acciaio ottonato per cilindri tondi diametro mm. 25.
 . Per cilindri serie 608.

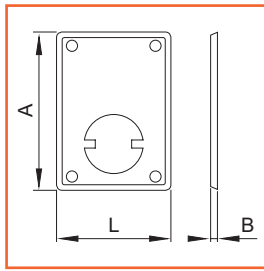

Codice SPS	Articolo	L mm.	A mm.	B mm.	Finitura	Imb.	UM	EAN
SWE800.07.000	800.07.00.0	50	60	2,2	ottonata	20	PZ	8 021012 045935



800.07

Borchia WELKA per cilindri tondi

. Borchia in acciaio ottonato per cilindri tondi diametro mm. 25.
 . Per cilindri serie 603.

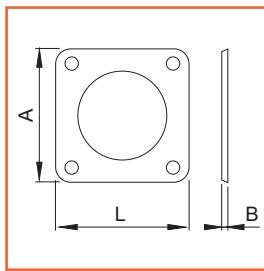

Codice SPS	Articolo	L mm.	A mm.	B mm.	Finitura	Imb.	UM	EAN
SWE800.02.000	800.02.00.0	43	43	2,2	ottonata	20	PZ	8 021012 045850



800.02

Borchia WELKA per cilindri tondi mm. 22

. Borchia in nylon nero per cilindri tondi diametro mm. 22.
 . Per cilindri serie 607.

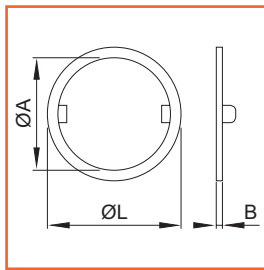

Codice SPS	Articolo	L mm.	A mm.	B mm.	Finitura	Imb.	UM	EAN
SWE805.04.000	805.04.00.0	32	22	2	nera	20	PZ	8 021012 045973



805.04